

ALL DIMENSIONS AND SETTING OUT ARE TO BE VERIFIED ON SITE AND ALL DISCREPANCIES REFERRED TO THE ARCHITECT BEFORE WORK COMMENCES. COPYRIGHT RESERVED



REV.	DATE	DESCRIPTION
A	08.04.21	MINOR UPDATE
B	14.04.21	EGD SPECIFICATION STORE ADDED
C	07.06.21	FED CROSSING ADDED, TRACKING UPDATED
D	28.06.21	ACCESS & CAR PARK UPDATED
E	21.07.21	RED LINE BOUNDARY UPDATED, COLOUR ADDED



'Subject To Survey'
Based upon the Ordnance Survey map with permission of The Controller of Her Majesty's Stationery Office, © Crown Copyright John Roberts Architects Limited 1 James Street, Lincoln LN2 1GD Licence No. AR 154164

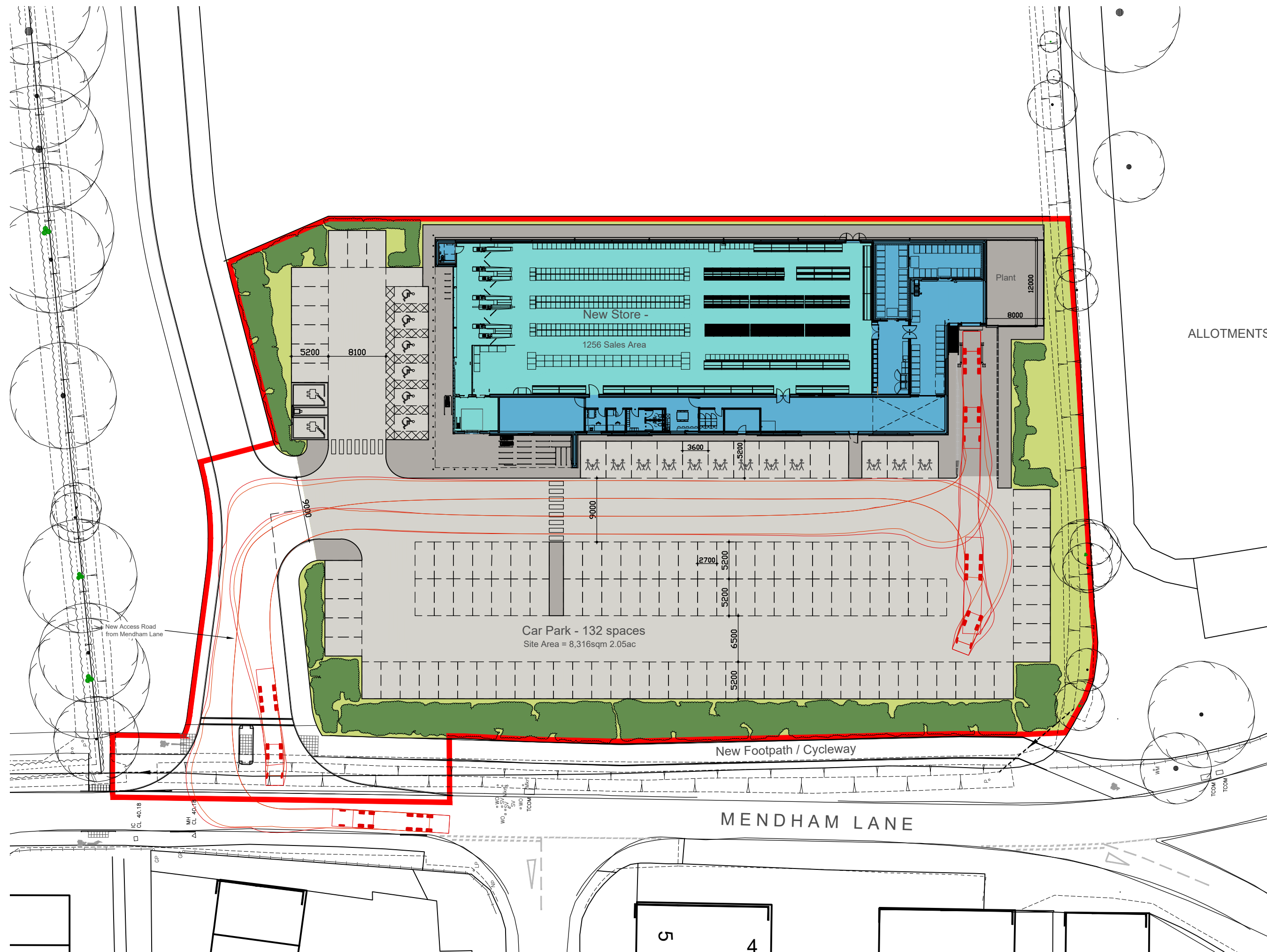

ALLOTMENTS

Site Layout	
Sales Area	1,256sqm
Ancillary Ground Floor	300sqm
Warehouse	344sqm
GIA	1,900sqm
Car Park Spaces	132
Lidl Site Area	8,316sqm
Application Site Area	9,376sqm



client
Lidl GB Ltd

project
New Lidl Store
Mendham Lane
Harleston

drawing
Proposed Site Plan

scale
1:250@A1, 1:500@A3

date
July 21

drawn
RM

checked

drawing no.
7910L-03

revision
E

john roberts architects

1 James Street . Lincoln . LN2 1GD
T: 01522 533441 . F: 01522 512888
E: contact@jraarchitects.co.uk
www.jraarchitects.co.uk

